

NOSE ASSEMBLY DATA SHEET

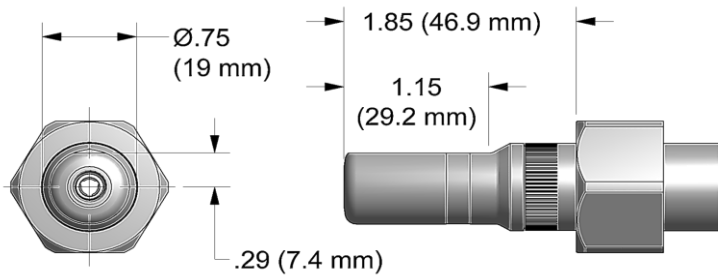

ASSEMBLY:

Notes:

- A. Apply Vibra-tite® p/n/ 405125 to all threads and allow it to set 20 minutes prior to assembly.
- B. If nose assy is assembled as it is when purchased new, follow steps 3-5 to attach to tool.

1. Insert super grip jaw assy (3) into rear of collet (2). (Note direction in exploded view).
2. Thread collet (2) to extension-collet (4) using hex key in front of collet-extension (4) and flats provided on collet (2).
3. Thread assembled collet (2) and extension-collet (4) onto piston of tool using flats provided and hex in rear of piston.
4. Slide anvil assy (1) over assembled collet (2).
5. Slide retaining nut stop and retaining nut over ears on anvil (see exploded view) and tighten to tool.

DISASSEMBLY:

Reverse assembly instructions.

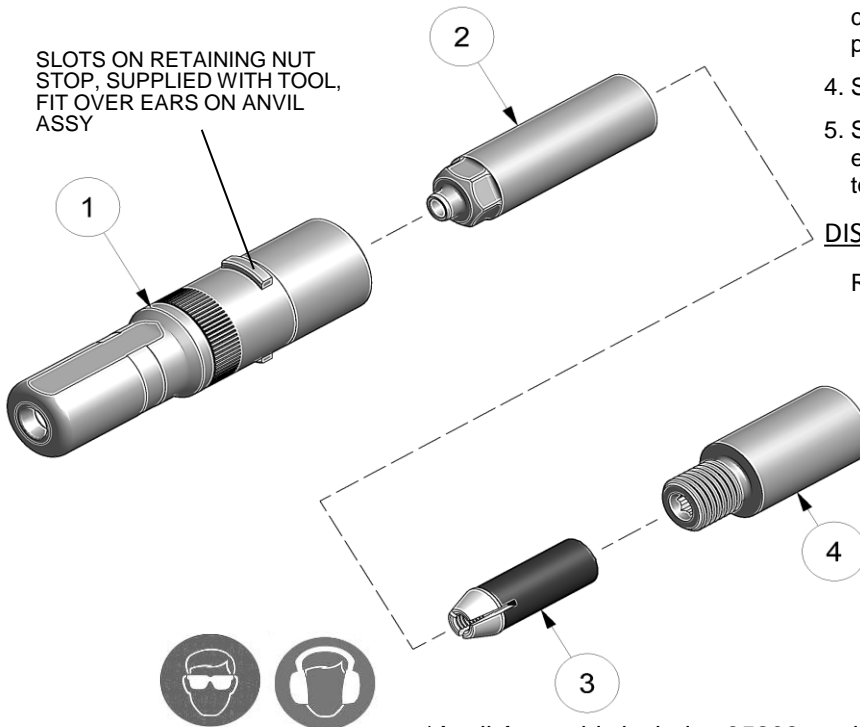

SLOTS ON RETAINING NUT STOP, SUPPLIED WITH TOOL, FIT OVER EARS ON ANVIL ASSY

*Anvil Assembly includes 35208 retainer.

**Blue band designates nose assemblies for metric GP® fasteners.

2/16 REV 10/18

GAGE BILT **INNOVATIVE TOOLING**
 MADE in USA ON THE LEADING EDGE OF AIRCRAFT TOOLING
 Est. 1986 | innovativetooling.com | 800-832-7009

Type:		Fasteners:	Recommended Tool:
Non Self-Releasing 4mm Ø		MGP® Lockbolts	GB731
			Alternate Tools: GB2480(A)
Ref. No.	Qty.	Description	MGP4-2480-20
1	1	Anvil Assy	10452
2	1	Collet	20414
3	1	Super-Grip Jaw Assy	30542-S
4	1	Extension-Collet	70550