

# NOSE ASSEMBLY DATA SHEET

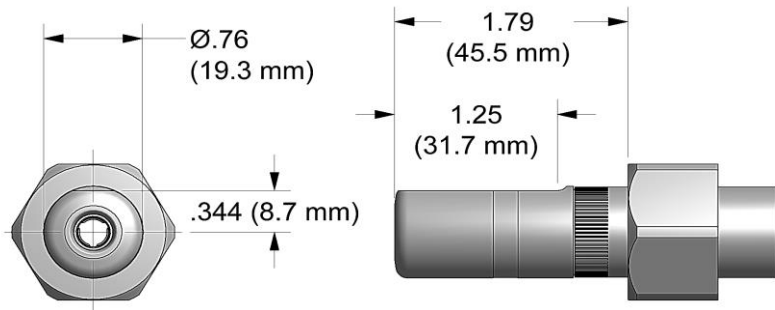

## ASSEMBLY:

**Note:** If nose assy is assembled as it is when purchased new, follow steps 3-5 to attach to tool.

1. Drop super grip jaw assy (3) into collet (2). (Note direction in exploded view).
2. Thread collet (2) onto extension-collet (4) and tighten using flats on collet (2) and hex in i.d. of extension-collet (4).
3. Thread assembled collet (2) and extension-collet (4) onto piston of tool and tighten using flats provided.
4. Slide anvil (1) over assembled collet (2).
5. Slide retaining nut stop and retaining nut on anvil (1) and tighten nose assy to tool.

SLOTS ON RETAINING NUT STOP, SUPPLIED WITH TOOL, FIT OVER EARS ON ANVIL ASSY

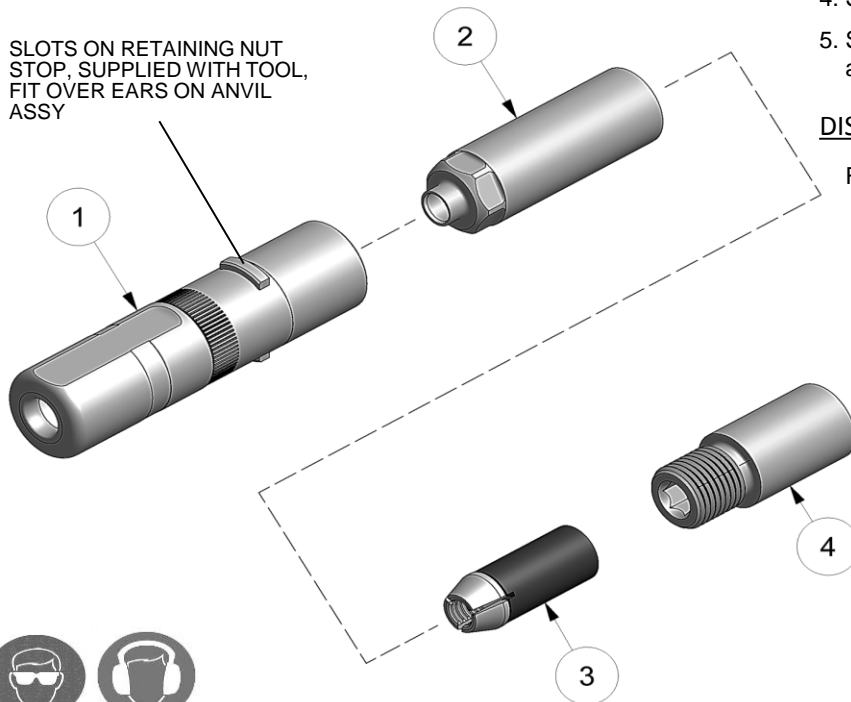

## DISASSEMBLY:

Reverse assembly instructions.



\*Anvil Assembly includes 35208 retainer.

\*\*Red band designates nose assemblies for metric lightweight GP® fasteners.

9/16 REV.10/16

**GAGE BILT** **INNOVATIVE TOOLING**  
 MADE in USA ON THE LEADING EDGE OF AIRCRAFT TOOLING  
 Est. 1986 | [innovativetooling.com](http://innovativetooling.com) | 800-832-7009

Type:		Fasteners:	Recommended Tool: GB731
Non Self-Releasing 6mm Ø		MLGP® Lockbolts	Alternate Tools: GB2480(A)
Ref. No.	Qty.	Description	MLGP6-2480-20
1	1	Anvil	16637
2	1	Collet	20869
3	1	Super-Grip Jaw Assy	30858-S
4	1	Extension-Collet	70835