

NOSE ASSEMBLY DATA SHEET

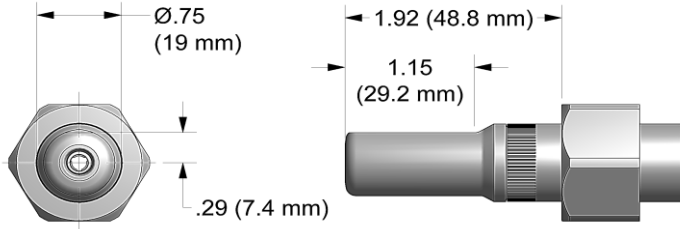

Slots on retaining nut stop, supplied with tool, fit over ears on anvil assembly

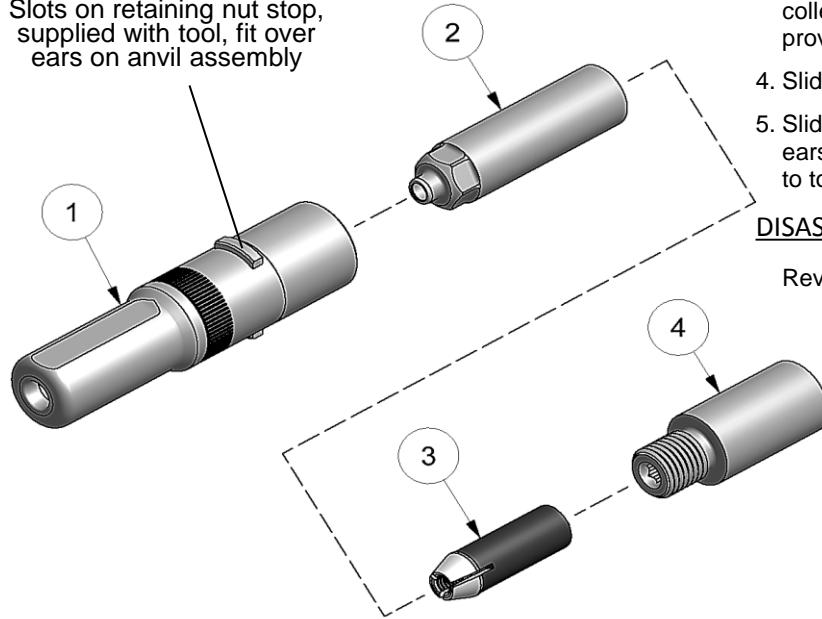

ASSEMBLY:

Note: If nose assy is assembled as it is when purchased new, follow steps 3-5 to attach to tool.

1. Insert super grip jaw assy (3) into rear of collet (2). (Note direction in exploded view).
2. Thread collet (2) to extension-collet (4) using flats provided .
3. Thread assembled collet (2) and extension-collet (4) onto piston of tool using flats provided and hex in rear of piston.
4. Slide anvil & holder assy (1) over collet (2).
5. Slide retaining nut stop and retaining nut over ears on anvil (see exploded view) and tighten to tool.

DISASSEMBLY:

Reverse assembly instructions.



3/16 REV 9/17

GAGE BILT INNOVATIVE TOOLING
 ON THE LEADING EDGE OF AIRCRAFT TOOLING
 Est. 1986 | innovativetooling.com | 800-832-7009

Type:

Fastener:

Recommended Tool:
GB731

Non Self-Releasing
5/32" Ø

NAS Shear Pull Type
Lockbolts, C6L® and GP® Lockbolts

Alternate Tools:
GB730 & GB2480(A)

Ref.
No.

Qty.

Description

NASS05-2480-20

1

1

Anvil Assy

10585

2

1

Collet

20414

3

1

Super-Grip Jaw Assy

30542-S

4

1

Extension-Collet

70550