

NOSE ASSEMBLY DATA SHEET

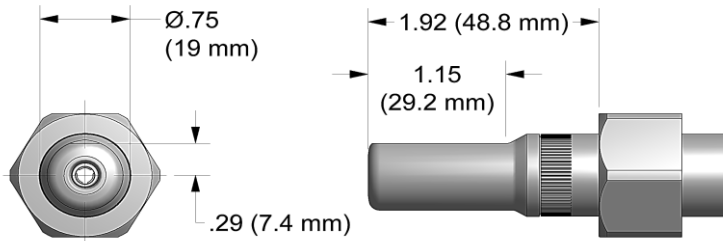

ASSEMBLY:

Note: If nose assy is assembled as it is when purchased new, follow steps 3-5 to attach to tool.

1. Insert super grip jaw assy (3) into rear of collet (2). (Note direction in exploded view).
2. Thread collet (2) to extension-collet (4) using flats provided .
3. Thread assembled collet (2) and extension-collet (4) onto piston of tool using flats provided and hex in rear of piston.
4. Slide anvil & holder assy (1) over collet (2).
5. Slide retaining nut stop and retaining nut over ears on anvil (see exploded view) and tighten to tool.

DISASSEMBLY:

Reverse assembly instructions.

Slots on retaining nut stop, supplied with tool, fit over ears on anvil assembly

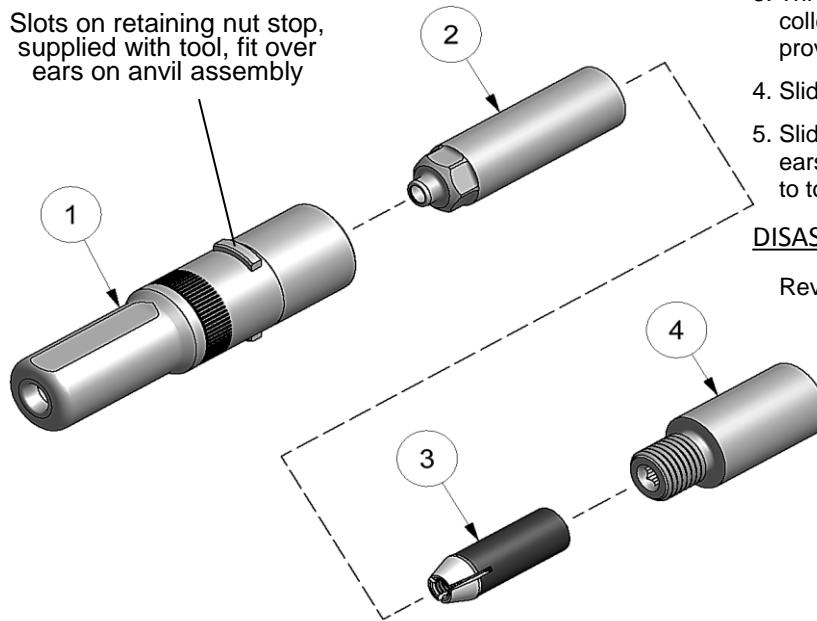

3/16 REV 9/17

GAGE BILT INNOVATIVE TOOLING
MADE in USA ON THE LEADING EDGE OF AIRCRAFT TOOLING
Est. 1986 | innovativetooling.com | 800-832-7009

| Type: | | Fastener: | Recommended Tool: |
|-------------------------------|------|------------------------------------|-------------------|
| Non Self-Releasing 5/32" Ø | | NAS Tension Pull Type Lockbolts | GB731 |
| Ref. No. | Qty. | Description | NAST05-2480-20 |
| 1 | 1 | Anvil Assy | 10565 |
| 2 | 1 | Collet | 20414 |
| 3 | 1 | Super-Grip Jaw Assy | 30542-S |
| 4 | 1 | Extension-Collet | 70550 |