

# NOSE ASSEMBLY DATA SHEET

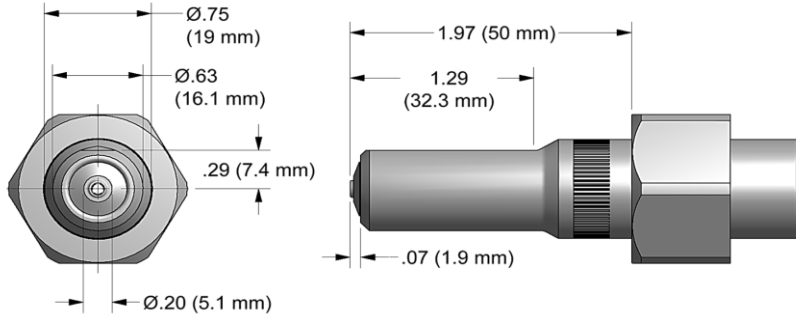

## ASSEMBLY:

**Note:** If nose assy is assembled as it is when purchased new, follow steps 3-5 to attach to tool.

1. Insert super grip jaw assy (4) into rear of collet (3). Place spacer (5) on rear of super grip jaw assy (4) (Note direction in exploded view).
2. Thread collet (3) to extension-collet (6) using hex key in front of collet-extension (6) and flats provided on collet (3).
3. Thread assembled collet (3) and extension-collet (6) onto piston of tool using flats provided and hex in rear of piston.
4. Slide anvil & holder assy (2) over collet (3).
5. Slide retaining nut stop and retaining nut over ears on anvil (see exploded view) and tighten to tool.

## DISASSEMBLY:

Reverse assembly instructions.

SLOTS ON RETAINING NUT STOP, SUPPLIED WITH TOOL, FIT OVER EARS ON ANVIL ASSY

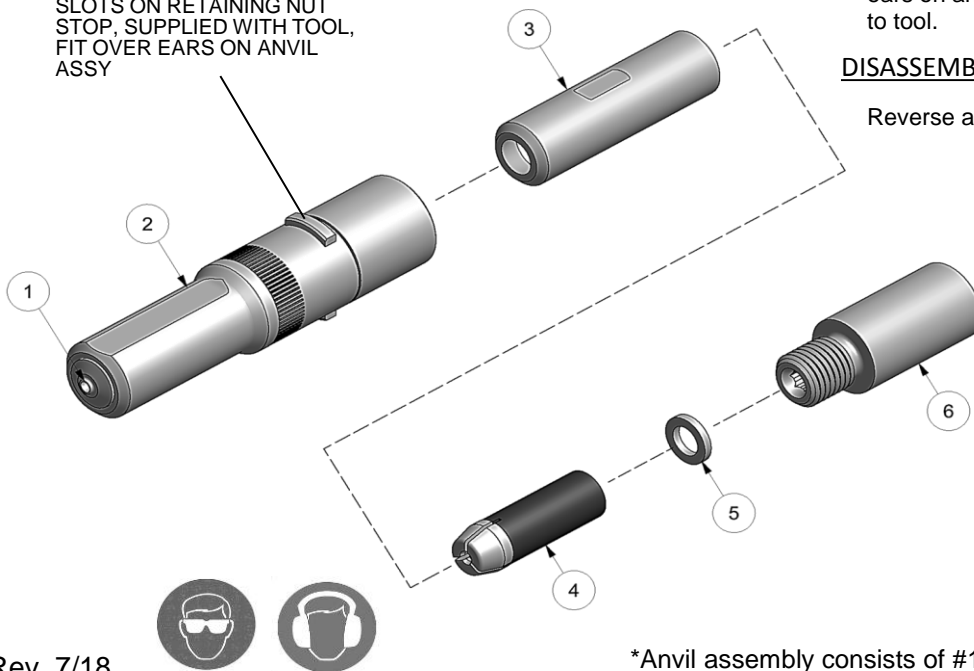

Rev. 7/18

\*Anvil assembly consists of #1 and 35208 retainer.

**GAGE BILT**  
MADE in USA

**INNOVATIVE TOOLING**  
ON THE LEADING EDGE OF AIRCRAFT TOOLING  
Est. 1986 | [innovativetooling.com](http://innovativetooling.com) | 800-832-7009

Type:		Fasteners:		Recommended Tool: GB751	
Non Self-Releasing 1/8" & 5/32" Ø		<b>BLIND RIVET (SINGLE ACTION) WITH OR W/OUT DRIVE WASHER NAS1900 S &amp; U SERIES</b>		Alternate Tools: GB722 & GB2480(A)	
Ref. No.	Qty.	Description	SMLS04-752C-20	SMLS05-752C-20	
1	1	Anvil Insert	10485	15596	
2	1	Anvil Assy (Inc. #1)	17746	17747	
3	1	Collet	20727	20727	
4	1	Super-Grip Jaw Assy	30425-CS	30545-CS	
5	1	Spacer	70572	70572	
6	1	Extension-Collet	70550	70550	