

GB722 INSTALLATION TOOL

GB722

Stroke - 0.590" (15.00 mm)
Weight - 5.50 lbs. (2.49 kg)
Pull load - 4,700 (20.91 kN)

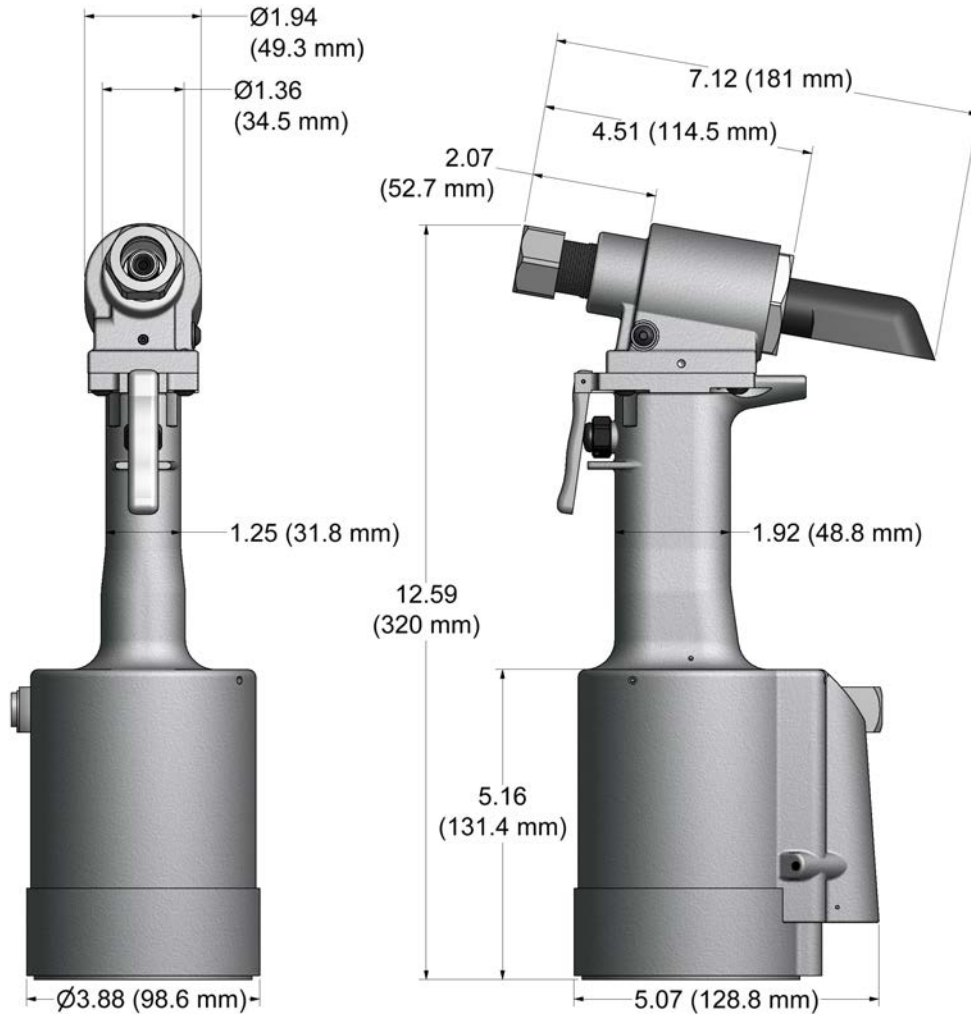

DESCRIPTION

The GB722 is a pneumatic-hydraulic tool designed specifically for the efficient installation of blind rivets and lockbolt fasteners. It weighs 5.50 lbs. (2.49 kg) and can be operated in any position. It has a 0.590" (15.0mm) rivet setting stroke and a rated pull load of 4,700 lbs (20.9 kN) with 90 psi (6.2 bar) air pressure at the air inlet.

The GB722 installation tool operates on 90 to 100 psi (6.2-6.9 bar) of air pressure, with 90 psi. (6.2 bar) providing the maximum efficiency. At 90 psi (6.2 bar) of air pressure, the GB722 does not exceed 81.5 dB(A) and consumes .16 SCF/cycle (4.53 L/cycle).

The air inlet is provided with 1/4-18 female pipe thread to accept the users air hose fitting.

NOSE ASSEMBLIES ARE NOT FURNISHED WITH TOOL AND MUST BE ORDERED SEPARATELY.

GAGE BILT
 **MADE in USA**

INNOVATIVETOOLING
On the leading edge of Aircraft Tooling
800-832-7009
sales@innovativetooling.com
innovativetooling.com



ACCESSORIES

AIR BLEEDER ASSY

#704153

(Sold Separately)



STEM CATCHER BAG

#756610

(Sold Separately)



ADAPTER ASSY

#751204

Adapts 204 offset series nose assemblies to GB722 installation tool.
(Sold Separately)

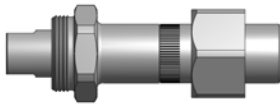

Other adapters available. Contact Gage Bilt for more information.

STROKE LIMITER

#722142

Required with all right angle nose assy's when used on GB722 tool.
(Sold Separately)



GRIP GAGE #GB105093

For NAS LOCKBOLTS and blind fasteners
(Sold Separately)



GRIP GAGE #269G3

For CHERRYMAX® and CHERRYLOCK® rivets
(Sold Separately)



GB722TKL TRAILER AND CAB KIT



GAGE BILT OFFERS A WIDE SELECTION OF STANDARD AND CUSTOM KITS TAILORED TO YOUR NEEDS.
(Sold Separately)

NOSE ASSEMBLIES

STRAIGHT
(Sold Separately)

RIGHT ANGLE
(Sold Separately)

OFFSET
(Sold Separately)

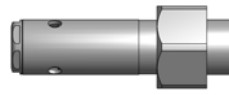

FASTENER	DIA.	STRAIGHT	*RIGHT ANGLE	**OFFSET
C6L® LOCKBOLTS	3/16 1/4	LB06-722-20 LB08-722-20	LB06-722-60 LB08-722-60	
MAGNA-GRIP® LOCKBOLTS MULTI-GRIP	3/16 1/4	MG06-722-20 MG08-722-20	MG06-722-60 MG08-722-60	
PROTRUDING HEAD, MAGNA-LOK® BLIND RIVETS	3/16 1/4	MGL06-752A-21 MGL08-752A-21	MGL06-752A-61 MGL08-752A-61	MGL06-713B-58RA MGL08-713B-58RA
COUNTERSUNK HEAD, MAGNA-LOK® BLIND RIVETS	3/16 1/4	MGLC06-752A-21 MGLC08-752A-21	MGLC06-752A-61 MGLC08-752A-61	
BLIND BOLT (SINGLE ACTION) WITH OR W/O DRIVE WASHER	1/8 5/32	SB04-752C-20 SB05-752C-20 SB05-752C-80	SB04-752C-45 SB05-752C-45 SB06-752B-45	SB04-751C-54RA SB05-751C-54RA
MS90353S & U / MS90354S & U MS21140S & U / MS21141S & U MAXIBOLT®, BACB30YY, YU, & YT	3/16 1/4	SB06-752B-20 SB06-752B-80 SB08-713-20	SB06-752B-45 SB08-713-45	SB06-751B-54RA SB08-204D-27OS
BLIND BOLT (SINGLE ACTION) WITH DRIVE WASHER	1/8 5/32	UBB04-752C-20 UBB05-752C-20 UBB05-752C-80	UBB04-752C-45 UBB05-752C-45 UBB06-752B-45	UBB04-751C-54RA UBB05-751C-54RA
MS90353S & U / MS90354S & U MS21140S & U / MS21141S & U MAXIBOLT®, BACB30YY, YU, & YT	3/16 1/4	UBB06-752B-20 UBB06-752B-80 UBB08-713-20	UBB06-752B-45 UBB08-713-45	UBB06-751B-54RA UBB08-204D-27OS
EN6122 & UAB130-EU EN6127 & UAB6127-EU EN6128 & UAB100-EU EN6129 & UABP-EU MAXIBOLT® PLUS	5/32 3/16 1/4	UAB568-713-20 UAB568-713-61	UAB05-751C-54RA UAB06-751B-54RA	UAB05-752B-43OS UAB06-752B-43OS UAB08-204D-27OS UAB08-204D-37OS
UNIMATIC® BLIND RIVET (SINGLE ACTION) WITH OR W/O DRIVE WASHER	1/8 5/32 3/16 1/4	SMLS04-752C-20 SMLS05-752C-20 SMLS06-752B-20 SMLS08-713-20	SMLS04-752C-45 SMLS05-752C-45 SMLS06-752B-45 SMLS08-713-45	SMLS04-751C-54RA SMLS05-751C-54RA SMLS06-751C-54RA SMLS08-751B-54RA
UNIMATIC® BLIND RIVET (SINGLE ACTION) WITH DRIVE WASHER	1/8 5/32 3/16 1/4	456UBR-751A-21 UBR08-713-20 UBR08-713-45	456UBR-751A-61 UBR08-713-45	456UBR-751B-54RA UBR08-751B-54RA
456MAX-731-43OS				
"A" CODE NAS1398A & NAS1399A	3/32 1/8 5/32 3/16 1/4	3A-352B-25 4A-752C-20 5A-752C-20 6A-752B-20 SMLS08-713-20	4A-752C-45 5A-752C-45 6A-752B-45 SMLS08-713-45	3A-751C-54RA 4A-751C-54RA 5A-751C-54RA 6A-751C-54RA SMLS08-751B-54RA
5A-752B-43OS 6A-752B-43OS SMLS08-204D-27OS SMLS08-204D-37OS				
MONOBOLT®	3/16 1/4	MB06-752A-21 MB08-752A-21	MB06-752A-61 MB08-752A-61	MB06-751C-54RA MB08-713-58RA
CONTAINER BOLT(R 12) HLPP, HLPV, HLPPE, HLPSS HLPS & HLPSP	3/8	HT12-713-20		
CHERRYMAX®, CHERRYMAX® 'AB', BACR15FR/FP, BACR15GF/GK	1/8 5/32 3/16 1/4	456MAX-751-23 08MAX-752B-20	456MAX-751A-61 08MAX-752B-45	456MAX-751D-54RA 08MAX-713A-58RA
456MAX-731-43OS 08MAX-204D-27OS 08MAX-204D-37OS				
NAS1900 S & U SERIES BLIND RIVET WITH DRIVE WASHER	1/4	08MAX-752B-20	08MAX-752B-45	08MAX-713A-58RA 08MAX-204D-27OS 08MAX-204D-37OS
ASP® ASP 2, ASP FF, ASP 4 FF, ASP 2 F, ASP 2 LC	13/64 17/64 21/64	ASPO6-752C-20 ASPO8-752B-20 ASPI0-713-20	ASPO6-752C-45 ASPO8-752B-45 ASPI0-713-45	ASPO6-751B-54RA ASPO8-751B-54RA ASPI0-204D-27OS ASPI0-204D-37OS
STANDARD MBC® NAS1719, NAS1720 NAS1721	1/8 5/32 3/16	MBC04-752C-20 MBC05-752C-20 MBC06-752B-20	MBC04-752C-45 MBC05-752C-45 MBC06-752B-45	MBC04-751C-54RA MBC05-751C-54RA MBC06-751C-54RA
MBC04-752C-43OS MBC05-752C-43OS MBC06-752C-43OS				
MBC® LOCK CREATOR NAS1719X(L), NAS1720X(L) NAS1721X(L)	1/8 5/32 3/16	456MAX-751-23 456MAX-751A-61	456MAX-751A-61 456MAX-751D-54RA	456MAX-751D-54RA 456MAX-731-43OS
GROUND STUD, MB3454 & BACS53B	8/32 10/32	GS8-752C-20 GS10-752B-20	GS8-752C-45 GS10-752B-45	GS8-751C-54RA GS10-752A-54RA GS10-752B-43OS

MONOBOLT® IS A REGISTERED TRADEMARK OF AVDEL UK LIMITED. ASP®, C6L®, UNIMATIC®, MAGNA-LOK® AND MAGNA-GRIP® ARE REGISTERED TRADEMARKS OF ARCONIC INC. CHERRYMAX®, MAXIBOLT® AND MBC® ARE REGISTERED TRADEMARKS OF CHERRY AEROSPACE FASTENERS.

GAGE BILT CERTIFIES THE GB722 WILL INSTALL THE ABOVE FASTENERS

*ALL -54RA RIGHT ANGLE NOSE ASSEMBLIES REQUIRE 722142 STROKE LIMITER.
**ALL OFFSET 204 SERIES NOSES REQUIRE 751204 ADAPTER.
1) INSTALLS 1/8 5/32 & 3/16 DIAMETERS
2) RIGHT ANGLE NOSE ASSEMBLIES MAY REQUIRE MORE THAN ONE PULL.
3) INSTALLS 5/32, 3/16 & 1/4 DIAMETERS.
4) 105 PSI REQUIRED FOR MS90353 & 54
5) THESE NOSES FOR LIGHT DUTY / REPAIR ONLY. CONSULT GAGE BILT FOR HIGH PRODUCTION APPLICATIONS.
6) 2 PULLS REQUIRED FOR MOST APPLICATIONS.
7) BACS53B -10 ONLY

NOTE: THE LAST 2 DIGITS OF THE NOSE ASSEMBLY REPRESENTS THE LENGTH THE NOSE EXTENDS FROM THE TOOL. I.E. -20 = 2.0 INCHES



Gage Bilt also supplies pin & collar swage inspection gages to certify swage installation.
(Sold Separately)

